

Ryeland Close, Yiewsley, West Drayton, UB7 8AU

- One Bedroom Apartment
- EPC Rating - D
- Large Apartment
- Close to Hillingdon Hospital
- Parking
- Part Furnished
- Popular Location
- Available Now

£1,250 PCM

Description

Cameron present to the market this one bedroom, second floor apartment located close to Hillingdon Hospital. The property offers a separate kitchen with white goods, shower-room, living room and a large than average bedroom. Located with easy reach of popular road links, Stockley Business park and local supermarkets. Presented part furnished, parking included and available NOW.

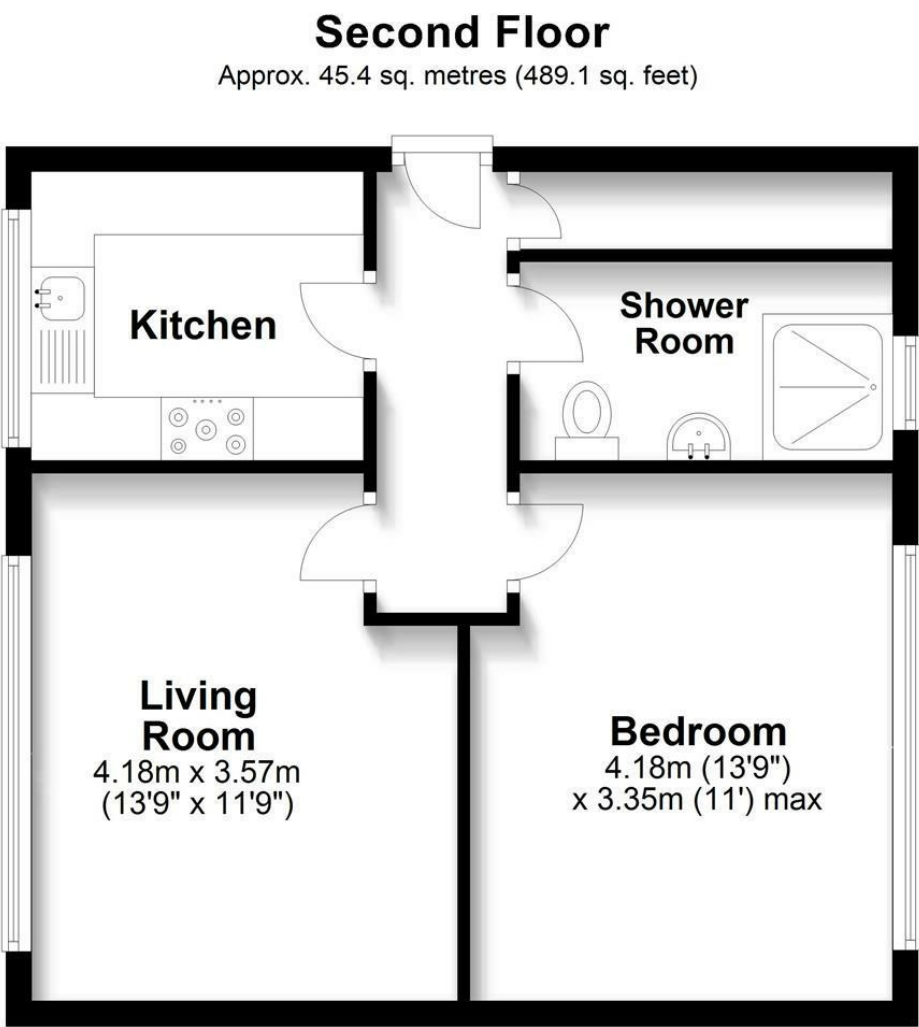

Total area: approx. 45.4 sq. metres (489.1 sq. feet)

IMPORTANT NOTICE

These particulars have been prepared upon information supplied by the Vendor and should be verified by your surveyors and solicitors. We have prepared these sales particulars as a general guide to give a broad description of the property. They are not intended to constitute part of an offer or contract. We have not carried out a structural survey and the services, appliances and specific fittings have not been tested. All photographs, measurements, floor plans and distances referred to are given as a guide only and should not be relied upon for the purchase of carpets or any other fixtures or fittings. Lease details service charge and ground rent (where applicable) are given as a guide only and should be checked and confirmed by your solicitor prior to exchange of contracts